

Sottotappi in polietilene standard

Sottotappi cilindrici

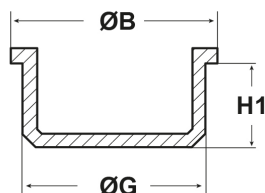

MAR-GOM
www.mar-gom.it
www.produzionegomma.it



Sottotappi in polietilene standard

Caratteristiche

I sottotappi solitamente si utilizzano sia all'interno dei fori (filettati o lisci) che sulle estremità tubolari come cappucci di protezione.

Materiale

Polietilene

Colore

Naturale

Cod.	ØG (mm)	ØB (mm)	H1 (mm)	adatto a tubo GAS/BSP	flange	Confezione (pz)
1197201	2	6.5	3	-	-	1000
1197202	2.5	6.5	3.5	-	-	1000
1197203	3	6.5	4.5	-	-	1000
1197204	3	6.5	4.5	-	-	1000
1197205	4	7.5	5	-	-	1000
1197206	4.5	8	5	-	-	1000
1197207	5	9	6	-	-	1000
1197208	5.5	9	6	-	-	1000
1197209	6	9.5	6	-	-	1000
1197210	6.5	10	7	-	-	1000
1197211	7	10	6	-	-	1000
1197212	7.5	10.5	6.5	-	-	1000
1197213	8	11	7	-	-	1000
1197214	8.5	11.5	7.5	-	-	1000
1197215	9	12	7.5	G1/8	-	1000
1197216	9.5	12.5	7.5	-	-	1000
1197217	10	13	8.5	-	-	1000
1197218	10.5	13.5	8.5	-	DN10	1000
1197219	11	14.5	8.5	-	-	1000
1197220	11.5	14.5	8.5	-	-	1000
1197221	12	14.5	9	G1/4	-	1000
1197222	12.5	15.5	9	-	-	1000
1197223	13	16.5	9.5	-	-	1000
1197224	13.5	16.5	9.5	-	-	1000
1197225	14	17.5	10	-	-	1000
1197226	14.5	17.5	9.5	-	-	1000
1197227	15	18	9.5	-	-	1000
1197228	15	18.5	9.5	G3/8	DN15	1000
1197229	16	19.5	10	-	-	1000
1197230	16.5	19.5	10.5	-	-	1000
1197231	17	20.5	10.5	-	-	1000
1197232	17.5	21	10.5	-	-	1000

1197233	18	21.5	10.5	-	-	1000
1197234	18.5	23	10	-	-	1000
1197235	19	22	10	G1/2	-	1000
1197236	19.5	23	10.5	-	-	1000
1197237	20	23.5	11	-	-	1000
1197238	20.5	24.5	10.5	-	DN20	1000
1197239	21	24.5	11	G5/8	-	1000
1197240	21.5	25.5	11	-	-	1000
1197241	22	25.5	11	-	-	1000
1197242	22.5	26	10.5	-	-	1000
1197243	23	27	10.5	-	-	1000
1197244	23.5	27.5	10.5	-	-	1000
1197245	24	28	11.5	-	-	1000
1197246	24.5	28	10.5	G3/4	-	1000
1197247	25	30	11	G3/4	-	1000
1197248	25.5	29	10.5	-	DN25	1000
1197249	26	30.5	10.5	-	-	1000
1197250	26.5	30	10.5	-	-	1000
1197251	27	31	9.5	-	-	1000
1197252	27.5	31	10.5	-	-	1000
1197253	28	32.5	10.5	-	-	1000
1197254	28.5	32	10	G7/8	-	1000
1197255	29	32	9.5	-	-	1000
1197256	29.5	33	10.5	-	-	1000
1197257	30	33	10	-	-	1000
1197258	30.5	34	10	-	-	500
1197259	31	36	10.5	G1	-	500
1197260	31.5	35	10.5	-	-	500
1197261	32	37	10.5	-	-	500
1197262	32.5	37.5	10.5	-	DN32	500
1197263	33	38	10.5	-	-	500
1197264	34	38.5	10.5	-	-	500
1197265	34.5	38	10.5	-	-	500
1197266	35	40	10.5	-	-	500
1197267	35.5	39	10.5	-	-	500
1197268	36	41	11	-	-	500
1197269	36.5	40	10.5	-	-	500
1197270	37	42	11	-	-	500
1197271	37.5	41.5	10.5	-	-	500
1197272	38	43	10.5	-	-	500
1197273	38.5	42	10.5	-	-	500
1197274	39	44	10.5	-	-	500
1197275	39.5	43.3	10.7	G1 1/4	-	500
1197276	40	45	10.5	-	-	500
1197277	41	46	10.5	-	-	500
1197278	42	46.5	10.5	-	-	500
1197279	43	47.8	10.7	-	-	500
1197280	44	49	10.5	-	-	500
1197281	45	50.8	10.6	-	-	500
1197282	46	50.8	10	G1 1/2	-	500
1197283	47	51.5	10.5	-	-	500
1197284	48	53	10.5	-	-	500
1197285	48.5	52	10.5	-	-	500
1197286	49	54.5	11	-	-	500

1197287	50	54	10	-	DN50	500
1197288	51	56	11	-	-	500
1197289	52	57.5	11	-	-	500
1197290	53	59	11	-	-	500
1197291	53.5	55.5	9.5	-	-	500
1197292	54	61	11	-	-	500
1197293	55	61	10	-	-	500
1197294	56	63	11.5	-	-	500
1197295	56.5	59.5	10.5	-	-	500
1197296	57	61	10	2	-	500
1197297	58	65	11	2	-	500
1197298	59	65	11	-	-	500
1197299	60	65	11	-	-	500
11972100	61	67.5	11	-	-	250
11972101	62	68	11	-	-	250
11972102	63	67	9.5	-	-	250
11972103	63.5	70	10.5	-	-	250
11972104	64	67.5	9.5	-	-	250
11972105	65	69	10	-	DN65	250
11972106	66	72	10	-	-	250
11972107	67	73	10	-	-	250
11972108	68	75	11	-	-	250
11972109	69	75	10.5	-	-	250
11972110	70	74	11	-	-	250
11972111	71	74.5	11	-	-	250
11972112	71.5	74.5	10.5	-	-	250
11972113	72	79	12	-	-	250
11972114	73	76.5	9.5	-	-	250
11972115	74	77.5	10.5	2 1/2	-	250
11972116	75	79	9.5	-	-	250
11972117	76	80	10.5	-	-	250
11972118	77	81	9.5	-	-	250
11972119	78	82	10.5	-	-	250
11972120	79	83	9.6	-	-	250
11972121	80	84	9.5	-	DN80	250
11972122	81	85	9.5	-	-	250
11972123	82	85.5	9.5	-	-	250
11972124	83	86.5	9.5	-	-	250
11972125	84	80	10	-	-	250
11972126	84.5	90	8	-	-	250
11972127	85	88.5	9.5	-	-	250
11972128	86	90	9.5	-	-	250
11972129	86.5	89	10	-	-	250
11972130	87	90.5	9.5	-	-	250
11972131	88	91.5	9.5	-	-	250
11972132	89	92.5	9.5	-	-	250
11972133	90	92.5	10	-	-	250
11972134	91	93	9.5	-	-	250
11972135	92	94.5	9.5	-	-	250
11972136	93	97	9.5	-	-	250
11972137	94	97	9.5	-	-	250
11972138	95	97	9	-	-	250
11972139	96	98	9.5	-	-	250
11972140	97	99	9.5	-	-	250

11972141	98	100	10	-	-	250
11972142	99	102	9.5	-	-	250
11972143	100	104.5	10.5	-	-	250
11972144	101	105	10.5	-	-	100
11972145	102	106	10.5	-	-	100
11972146	103	106	11	-	-	100
11972147	104	106.5	11	-	-	100
11972148	105	108	10.5	-	-	100
11972149	106	109.5	10.5	-	-	100
11972150	107	110	10.5	-	-	100
11972151	108	111.5	10.5	-	-	100
11972152	110	114	12.5	-	-	100
11972153	111	115	12.7	4	-	100
11972154	112	116	10.5	-	-	100
11972155	115	118.5	12	-	-	100
11972156	117	124	12	-	-	100
11972157	121	124	12	-	-	100
11972158	125	130	13.5	-	-	100
11972159	128	132	13.5	-	-	100
11972160	130	134	13.5	-	-	100
11972161	132	136.5	13	-	-	100
11972162	135	141	12.5	-	-	100
11972163	140	144	13.5	-	-	100
11972164	142	146	13.5	-	-	100
11972165	146	152	12	-	-	100
11972166	150	154	14.5	-	-	100
11972167	152	156	15	-	-	100
11972168	155	161	12	-	-	100
11972169	160	167	14	-	-	100
11972170	162	169	14	-	-	100
11972171	165	171	12	-	-	100
11972172	167	178	17.5	-	-	100
11972173	169	175	12	-	-	100
11972174	170	175.6	13.6	-	-	100
11972175	172	177.6	13.6	-	-	100
11972176	176	182	12	-	-	100
11972177	180	187	14.5	-	-	100
11972178	182	189	14.5	-	-	100
11972179	184	194	16	-	-	100
11972180	186	194	16	-	-	100
11972181	190	195.6	13.6	-	-	100
11972182	192	197.6	13.6	-	-	100
11972183	200	208	14	-	-	100
11972184	202	210	14	-	-	100
11972185	208	220	15	-	-	100
11972186	211	217	12	-	-	100
11972187	214	220	13.5	-	-	100
11972188	221	227	12	-	-	100
11972189	230	236	12	-	-	100
11972190	232	242.6	13.5	-	-	100
11972191	233	245	16	-	-	100
11972192	250	259	14.5	-	-	100
11972193	252	261	14.5	-	-	100
11972194	261	273	16	-	-	100

11972195	285	298	18	-	-	100
11972196	302	309.6	18.5	-	-	100
11972197	311	324	18	-	-	100
11972198	390	400	19	-	-	100